



# Conference and Facility Hire



Keep in touch with us:

 /GTGTraining  @GTG\_Training  GTG Training

[gtg.co.uk](http://gtg.co.uk)



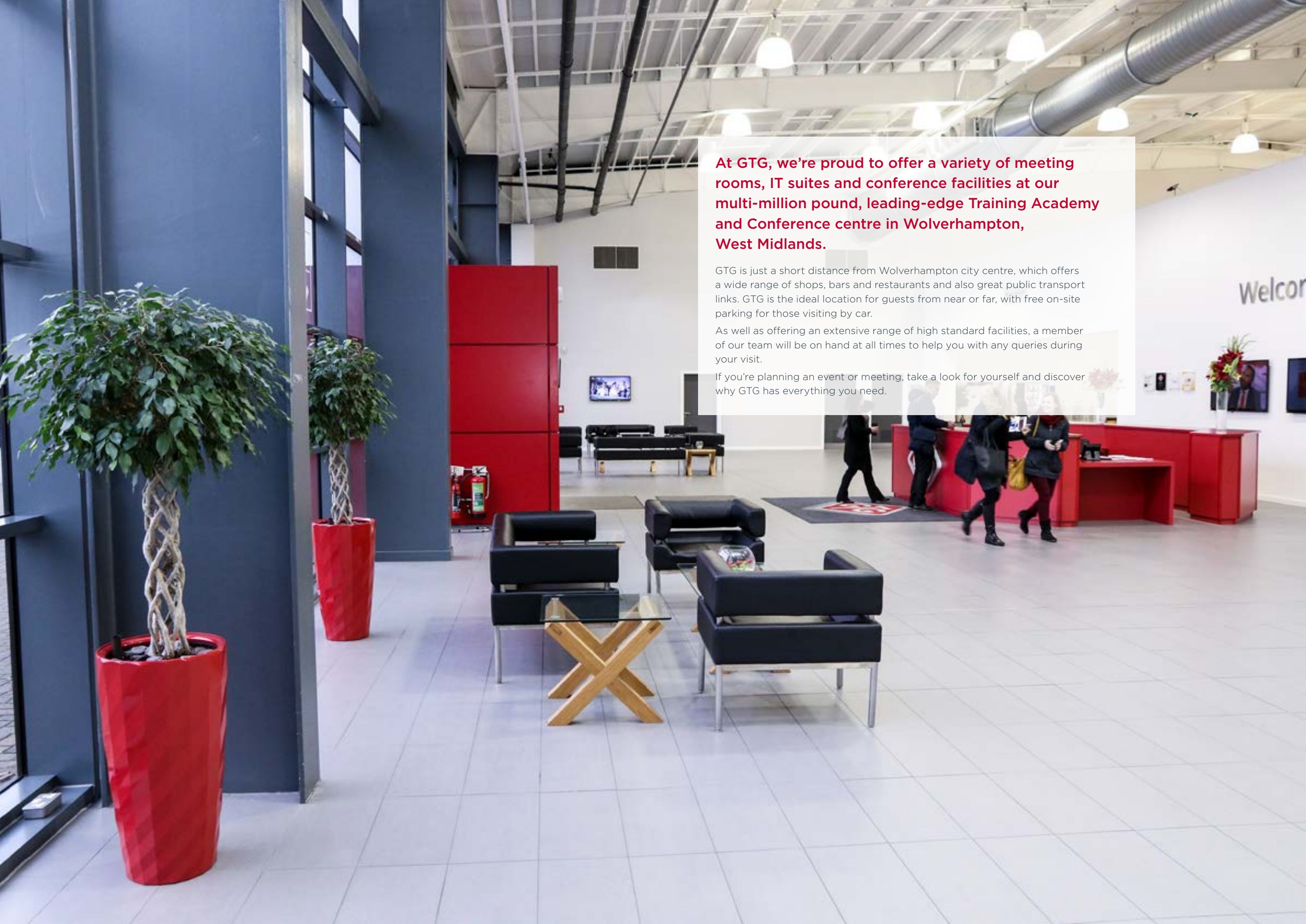

**At GTG, we're proud to offer a variety of meeting rooms, IT suites and conference facilities at our multi-million pound, leading-edge Training Academy and Conference centre in Wolverhampton, West Midlands.**

GTG is just a short distance from Wolverhampton city centre, which offers a wide range of shops, bars and restaurants and also great public transport links. GTG is the ideal location for guests from near or far, with free on-site parking for those visiting by car.

As well as offering an extensive range of high standard facilities, a member of our team will be on hand at all times to help you with any queries during your visit.

If you're planning an event or meeting, take a look for yourself and discover why GTG has everything you need.





Opened in 2013, GTG Training Academy was built on the success of existing training centres in Glasgow and Edinburgh and mirrors the same quality, expert training and conference facilities.

Designed to host events of varying sizes, this contemporary venue is equipped with every technological and presentation requirement you will need. You can choose from a variety of layouts for each of our meeting rooms, as well as a range of IT suites, breakout areas and a spacious conference area.

### Meeting rooms

Our rooms are fully equipped for any type of training and can be configured to suit your individual needs. All rooms include:

- Dry marker board
- Flipchart
- Projector and screen
- Wi-Fi
- Air conditioning

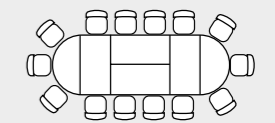

Boardroom

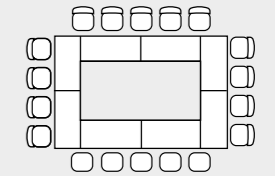

Hollow Square

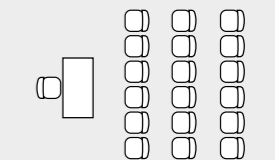

Theatre

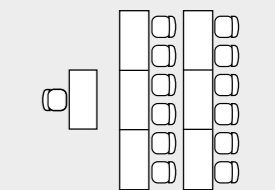

Classroom

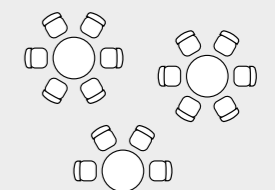

Cabaret

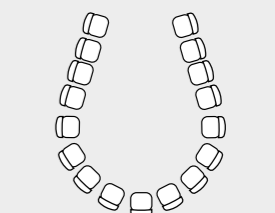

Horseshoe

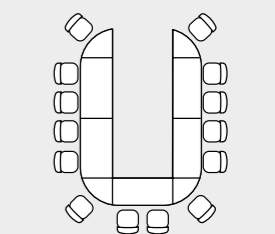

U-shaped





---

## IT suites

Our IT suites are available to hire complete with all the equipment you need, and our expert IT support staff will help to ensure that everything is ready for your delegates, including pre-installing software prior to your arrival.

All IT suites include:

- Networked desktop PCs, including one for the trainer
- Printer
- Dry marker board
- Projector and screen
- Wi-Fi
- Air conditioning
- Microsoft Office on all computers



---

## Food and refreshments

Thanks to our on-site café/restaurant, you can either tuck into something from our daily menu or choose a special menu from our selection of delegate packages, which can be tailored to cater to your individual requirements. Whether you'd like tea, coffee, cake and sandwiches or a full sit-down meal, we have something to satisfy everyone.

## Conference facilities

We have a generously proportioned 250-seat, theatre-style conference suite, ideal for large training events, product launches and awards ceremonies. The flexible conference suite can also be broken down into separate areas depending on requirements, and can accommodate a variety of room layouts. It features the latest audio-visual seminar technology, along with WiFi, projector screens and air conditioning.

You will find the conference suite is adjacent to the main foyer area, which creates an ideal venue to set up catering and refreshments for your delegates.

## Floor plans and room information

Covering the main ground floor area, we have a selection of fully equipped rooms available in various sizes and layouts.

Every room is named after a popular historical figure from around the local area, and a short biography of their namesake is displayed near each door. Ideal for brushing up on local history, these can provide great conversation starters.

| GTG West Midlands room information |            |           |           |          |               |         |                        |       |                     |        |             |            |
|------------------------------------|------------|-----------|-----------|----------|---------------|---------|------------------------|-------|---------------------|--------|-------------|------------|
| Room Name                          | Capacities |           |           |          |               |         | Dimensions (in metres) |       |                     |        |             |            |
|                                    | Theatre    | Classroom | Boardroom | U Shaped | Hollow Square | Cabaret | Length                 | Width | Area M <sup>2</sup> | Height | Door Height | Door Width |
| Attwood                            | 55         | 20        | 20        | 22       | 22            | 36      | 9                      | 7     | 63                  | 3.00   | 2.80        | 0.90       |
| Chance                             | 55         | 20        | 20        | 22       | 22            | 36      | 9                      | 7     | 63                  | 3.00   | 2.80        | 0.90       |
| Cook                               | 55         | 40        | 20        | 22       | 22            | 36      | 9                      | 7     | 63                  | 3.00   | 2.80        | 0.90       |
| Cotterill                          | 55         | 40        | 20        | 22       | 22            | 36      | 9                      | 7     | 63                  | 3.00   | 2.80        | 0.90       |
| Chance, Cook & Cotterill           | 250        | 60        |           | 58       | 64            | 120     | 9                      | 21    | 189                 | 3.00   | 2.80        | 0.90       |
| Darby                              | 20         | 12        | 10        | 12       | 14            | 14      | 7                      | 5     | 35                  | 3.00   | 2.80        | 0.90       |
| Dora                               | 20         | 12        | 10        | 12       | 14            | 14      | 7                      | 5     | 35                  | 3.00   | 2.80        | 0.90       |
| Dudley                             | 20         | 12        | 10        | 12       | 14            | 14      | 7                      | 5     | 35                  | 3.00   | 2.80        | 0.90       |
| Foley                              | 55         | 20        | 20        | 22       | 22            | 36      | 9                      | 7     | 63                  | 3.00   | 2.80        | 0.90       |
| Owen                               | 55         | 20        | 20        | 22       | 22            | 36      | 9                      | 7     | 63                  | 3.00   | 2.80        | 0.90       |
| Tinsley                            | 55         | 20        | 20        | 22       | 22            | 36      | 9                      | 7     | 63                  | 3.00   | 2.80        | 0.90       |
| Wilkinson                          | 55         | 20        | 20        | 22       | 22            | 36      | 9                      | 7     | 63                  | 3.00   | 2.80        | 0.90       |
| Walters                            | 40         | 20        | 12        | 18       | 22            | 32      | 8                      | 6     | 56                  | 3.00   | 2.80        | 0.90       |
| Classroom 1                        |            | 18        |           |          |               |         | 9                      | 6     | 54                  | 3.00   | 2.80        | 0.90       |
| Classroom 2                        |            | 18        |           |          |               |         | 9                      | 6     | 56                  | 3.00   | 2.80        | 0.90       |
| Classroom 3                        |            | 18        |           |          |               |         | 9                      | 6     | 54                  | 3.00   | 2.80        | 0.90       |
| Technical 1                        |            | 12        |           |          |               |         | 7                      | 4.8   | 34                  | 3.00   | 2.80        | 0.90       |
| Technical 2                        |            | 18        |           |          |               |         | 8.4                    | 3.5   | 29                  | 3.00   | 2.80        | 0.90       |

| GTG West Midlands room equipment |           |        |            |           |                |               |              |            |             |                  |          |              |              |             |                  |
|----------------------------------|-----------|--------|------------|-----------|----------------|---------------|--------------|------------|-------------|------------------|----------|--------------|--------------|-------------|------------------|
| Room Name                        | IT        |        |            |           |                | Presentation  |              |            |             | Lighting         |          |              |              |             |                  |
|                                  | Computers | Type   | Printer    | Networked | Internet/Wi-Fi | LCD Projector | Marker Board | Flip Chart | Type        | In Room Controls | Blackout | Sound System | Partitioning | Phone Point | Air Conditioning |
| Chance                           | 22        | Laptop | Mono Laser | ✓         | ✓              | ✓             | ✓            | ✓          | Fluorescent | ✓                | ✓        | ✓            | ✓            | ✓           | ✓                |
| Cook                             | 22        | Laptop | Mono Laser | ✓         | ✓              | ✓             | ✓            | ✓          | Fluorescent | ✓                | ✓        | ✓            | ✓            | ✓           | ✓                |
| Cotterill                        | 22        | Laptop | Mono Laser | ✓         | ✓              | ✓             | ✓            | ✓          | Fluorescent | ✓                | ✓        | ✓            | ✓            | ✓           | ✓                |
| Darby                            | 12        | Laptop | Mono Laser | ✓         | ✓              | ✓             | ✓            | ✓          | Fluorescent | ✓                | ✓        | ✓            | ✓            | ✓           | ✓                |
| Dora                             | 12        | Laptop | Mono Laser | ✓         | ✓              | ✓             | ✓            | ✓          | Fluorescent | ✓                | ✓        | ✓            | ✓            | ✓           | ✓                |
| Dudley                           | 12        | Laptop | Mono Laser | ✓         | ✓              | ✓             | ✓            | ✓          | Fluorescent | ✓                | ✓        | ✓            | ✓            | ✓           | ✓                |
| Attwood                          | 22        | Laptop | Mono Laser | ✓         | ✓              | ✓             | ✓            | ✓          | Fluorescent | ✓                | ✓        | ✓            | ✓            | ✓           | ✓                |
| Foley                            | 22        | Laptop | Mono Laser | ✓         | ✓              | ✓             | ✓            | ✓          | Fluorescent | ✓                | ✓        | ✓            | ✓            | ✓           | ✓                |
| Owen                             | 22        | Laptop | Mono Laser | ✓         | ✓              | ✓             | ✓            | ✓          | Fluorescent | ✓                | ✓        | ✓            | ✓            | ✓           | ✓                |
| Tinsley                          | 22        | Laptop | Mono Laser | ✓         | ✓              | ✓             | ✓            | ✓          | Fluorescent | ✓                | ✓        | ✓            | ✓            | ✓           | ✓                |
| Wilkinson                        | 22        | Laptop | Mono Laser | ✓         | ✓              | ✓             | ✓            | ✓          | Fluorescent | ✓                | ✓        | ✓            | ✓            | ✓           | ✓                |
| Walters                          | 22        | Laptop | Mono Laser | ✓         | ✓              | ✓             | ✓            | ✓          | Fluorescent | ✓                | ✓        | ✓            | ✓            | ✓           | ✓                |
| Classroom 1                      | 18        | Laptop | Mono Laser | ✓         | ✓              | ✓             | ✓            | ✓          | Fluorescent | ✓                | ✓        | ✓            | ✓            | ✓           | ✓                |
| Classroom 2                      | 18        | Laptop | Mono Laser | ✓         | ✓              | ✓             | ✓            | ✓          | Fluorescent | ✓                | ✓        | ✓            | ✓            | ✓           | ✓                |
| Classroom 3                      | 18        | Laptop | Mono Laser | ✓         | ✓              | ✓             | ✓            | ✓          | Fluorescent | ✓                | ✓        | ✓            | ✓            | ✓           | ✓                |
| Technical 1                      | 12        | Laptop | Mono Laser | ✓         | ✓              | ✓             | ✓            | ✓          | Fluorescent | ✓                | ✓        | ✓            | ✓            | ✓           | ✓                |
| Technical 2                      | 18        | Laptop | Mono Laser | ✓         | ✓              | ✓             | ✓            | ✓          | Fluorescent | ✓                | ✓        | ✓            | ✓            | ✓           | ✓                |

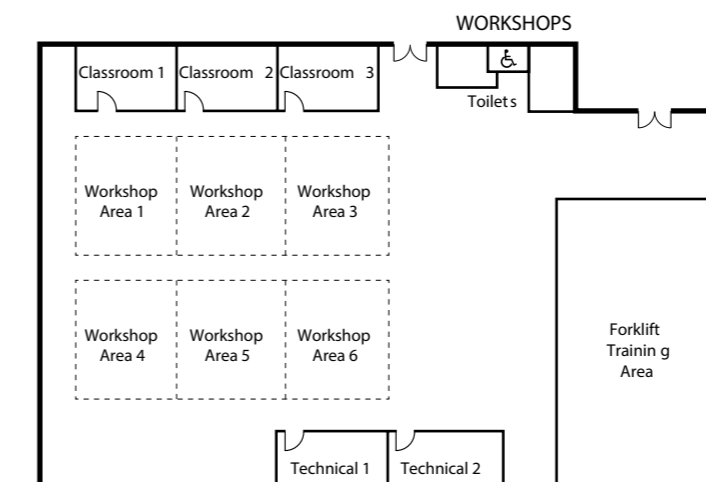
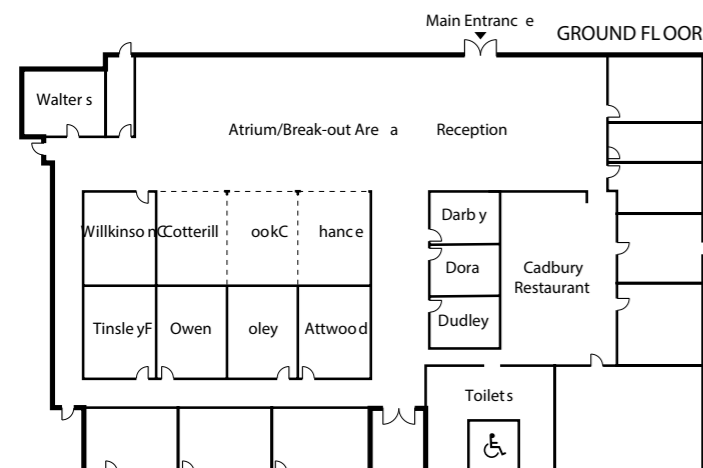



---

## Wolverhampton and beyond

**At GTG we understand that there's more to life than work. There is a variety of attractions and places to visit nearby and we are more than happy to offer our recommendations.**

With over 600 shops, bars and restaurants, Wolverhampton is a great place to spend time after a busy working week. If you like shopping, there is a wide selection of stores, from high street brands to indoor and outdoor markets. Bentley Bridge, a lively retail and leisure park, is less than a mile from GTG, boasting a cinema, bowling alley, swimming and fitness centre, plus a range of restaurants.

You can also take in a movie or play at one of Wolverhampton's cinemas and theatres.

For football fans, Molineux Stadium is home to Wolverhampton Wanderers Football Club and is just a short distance away. If horse racing is more your style, Wolverhampton Racecourse is situated less than two miles from the city centre and is part of the Holiday Inn Hotel.

Don't forget, this is just an example of what Wolverhampton has to offer – please speak to a member of our events team for more recommendations.

---

## How to find us

### By car

From Junction 10 on the M6 (approximately 10 minutes by car)  
From Junction 10 on the M6, take the A454 westbound towards Wolverhampton and take the 3rd turning left to follow the A454. At the roundabout take the 2nd turning and continue to follow the A454. At the next roundabout take the 2nd turning and follow this road until you come to a set of traffic lights. At these lights turn right into Neachells Lane, go past the Mercedes-Benz truck garage on the right, then and up and over the bridge. At the next roundabout turn right then straight over the next roundabout and take the first turn right into Bearing Drive. Continue to the bottom of the drive into GTG Training. GTG offers ample free parking.

### Air

Leave Birmingham Airport and travel north on the M42 then take the M6 towards Junction 10 (see Car section for further directions).

### Train

All trains arrive at Wolverhampton Train Station you should then take the above bus numbers to get to GTG Training. (see bus section for further instructions).

### Bus

From Wolverhampton Bus Station, situated next to the train station, buses 18, 25, 68, 69, 89 and 560 take you to within 7 minutes' walk from GTG. Please alight at High St/ Church St, Wednesfield.

